

ALL DIMENSIONS TO BE CHECKED ON SITE  
NO DIMENSIONS TO BE SCALED FROM THIS DRAWING  
DRAWING IS TO BE READ IN CONJUNCTION WITH RELEVANT CONSULTANTS DRAWINGS

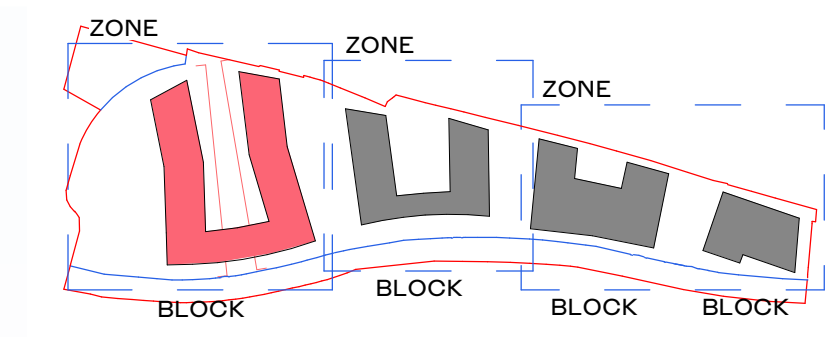

**SITE DRAWINGS LEGEND:**  
REFER TO BARRÉT MAHONY CIVIL ENGINEERING DRAWINGS FOR ALL DRAINAGE/ ROAD INFORMATION.  
SURVEY INFORMATION PROVIDED BY JONES ENGINEERING ON 23.4.2019.  
PLEASE REFER TO THE PAUL HOGARTH COMPANY LANDSCAPE DRAWINGS FOR ALL INFORMATION ON EXISTING AND PROPOSED TREES, MATERIAL FINISHES AND LAYOUT. ANY REFERENCE TO TREES/ HARD OR SOFT LANDSCAPING IN THIS DRAWING ARE INDICATIVE ONLY.

- HJL ELEVATION FINISHES LEGEND**
- | Key Value | Keynote Text  |
|-----------|---|
| 01        | TEXTURED BRICK FROM SELECTED PALETTE                                      |
| 02        | CERAMIC PANELS OR POLISHED RECONSTITUTED STONE PANEL                      |
| 03        | COMPOSITE ALUMINUM FRAME WINDOW SYSTEM TO SELECT FINISH                   |
| 04        | PPC STEEL BALUSTRADE TO SELECT FINISH                                     |
| 06        | PRECAST CONCRETE LINTEL   |
| 07        | PPC ALUMINUM PANEL TO SELECT RAL FINISH                                   |
| 08        | BAGUETTE STYLE CERAMIC OR POLISHED RECONSTITUTED STONE SCREEN             |
| 09        | CAST IN SITU FAIR FACED CONCRETE  |
| 10        | FAIR FACED CONCRETE LOW RISE WALL   |
| 11        | TOGGLE FIXED GLAZING WITH POWDER COATED VERTICAL MULLIONS TO SELECTED RAL |
| 12        | TEXTURED BRICK SOLDIER COURSE FROM SELECTED PALETTE                       |
| 13        | FAIR FACED CONCRETE PLINTH  |
| 14        | PPC ALUMINUM LOUVRES  |
| 15        | METAL LETTERING - BUILDING  |
| 16        | METAL LETTERING - SHOP, RESTAURANT  |
| 17        | PPC ALUMINUM DOOR TO SELECT RAL FINISH                                    |
| 18        | VERTICAL METAL SCREENS  |



1 BLOCK A - COURTYARD EAST ELEVATION  
1:200

- PLANNING APPLICATION
- SITE BOUNDARY
- PLANNING APPLICATION
- OWNERSHIP OF APPLICANT



2 BLOCK A - COURTYARD WEST ELEVATION  
1:200

ALL APARTMENT TYPES SHOULD BE READ IN CONJUNCTION WITH DRAWING NO.S P1601, P1602, P1603, P1604 AND HOUSING QUALITY

REV	DATE	DESCRIPTION	CHK	DRN
P2	26/11/2019	ISSUED FOR PLANNING APPROVAL	DB	OJ
P1	05/08/2019	ISSUED FOR PAC REQUEST	DB	OJ

STATUS CODE DESCRIPTION  
**ISSUED FOR PLANNING APPROVAL**

CLIENT  
Atlas GP Limited

PROJECT  
Project Claremont

DRAWING  
BLOCK A - ELEVATIONS 03  
COURTYARD - EAST & WEST ELEVATION

PROJECT NUMBER 950520 DATE 26/11/19

SCALE: A1: As indicated DRAWN/CHECKED: OJ/ DB

REVISION P2 DRAWING NUMBER CLR-HJL-01-XX-DR-A-2003A STATUS CODE: A1

**Henry J Lyons**

Architecture + Interiors +353 1 888 3333 53.54 Pearse Street  
henryjlyons.com info@henryjlyons.com Dublin D02 K466